

Installation Instruction

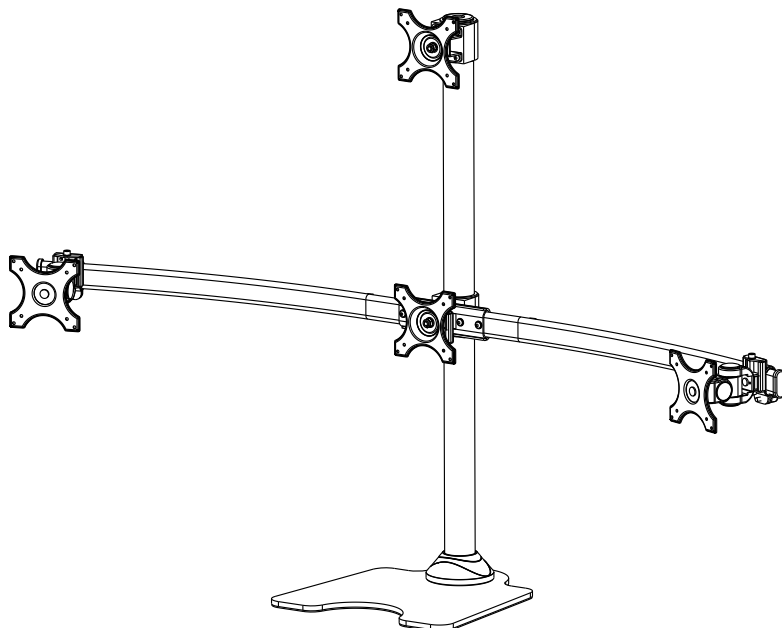

UNPACKING INSTRUCTIONS

- Carefully open the carton, remove contents and lay out on cardboard or other protective surface to avoid damage.
- Check package contents against the Supplied Parts List in the next page to assure that all components were received undamaged. Do not use damaged or defective parts.
- Carefully read all instructions before attempting installation.

IMPORTANT SAFETY INFORMATION

- Install and operate this device with care. Please read this instruction before installation, and carefully follow all instructions contained herein. Use proper safety equipment during installation.
- Please call a qualified installation contractor for help if you don't understand these directions or have any doubts about the safety of the installation.

Do not use this product for any purpose or in any configuration not explicitly specified in this instruction. We hereby disclaims any and all liability for injury or damage arising from incorrect assembly, incorrect mounting, or incorrect use of this product.

Supplied Parts List

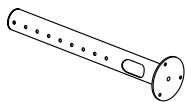

(1) 48mm Pole-a

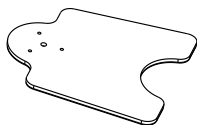

(1) Weighted Base-b

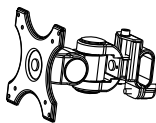

(2) Side Vesa Plate with Slip Set-c1

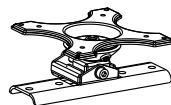

(1) Middle Vesa Plate-c2

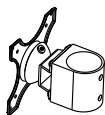

(1) Middle Top Vesa Plate-d



(2) Curved Arm-e

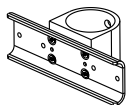

(1) Arm Clamp-f



(4) M6x25 Bolt-g



(4) M6 Washer-h

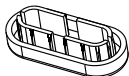

(2) Arm Plastic Cover-i



(7) M8x12 Bolt-j



(1) Decorative Cover-k

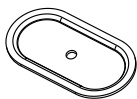

(1) Grommet Plate-l



(1) M10 Grommet Bolt-m

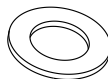

(1) M10 Washer-n1



(1) Spring Washer-n2

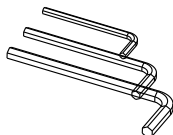

(1) Allen Key-o



(16) M4x12 Bolt-p



(16) M4x30 Bolt-q

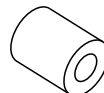

(16) M4 Spacer-r

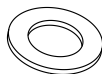

(3) M8 Washer-s

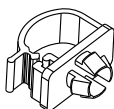

(2) Wire Clip-t



(1) Wrench-u

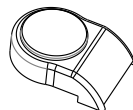

(2) Spare Plastic Cover-v

Step 1

Mounting the base according to your requirement

The stand can be used with the weighted metal base or there is a desk attachment provided (as drawings on the bottom) allowing you to mount the stand on a desk. This is very simple to install and just requires a hole drilling (10mm diameter) in your desk and clamping with the bolt and large washer.

Option 1

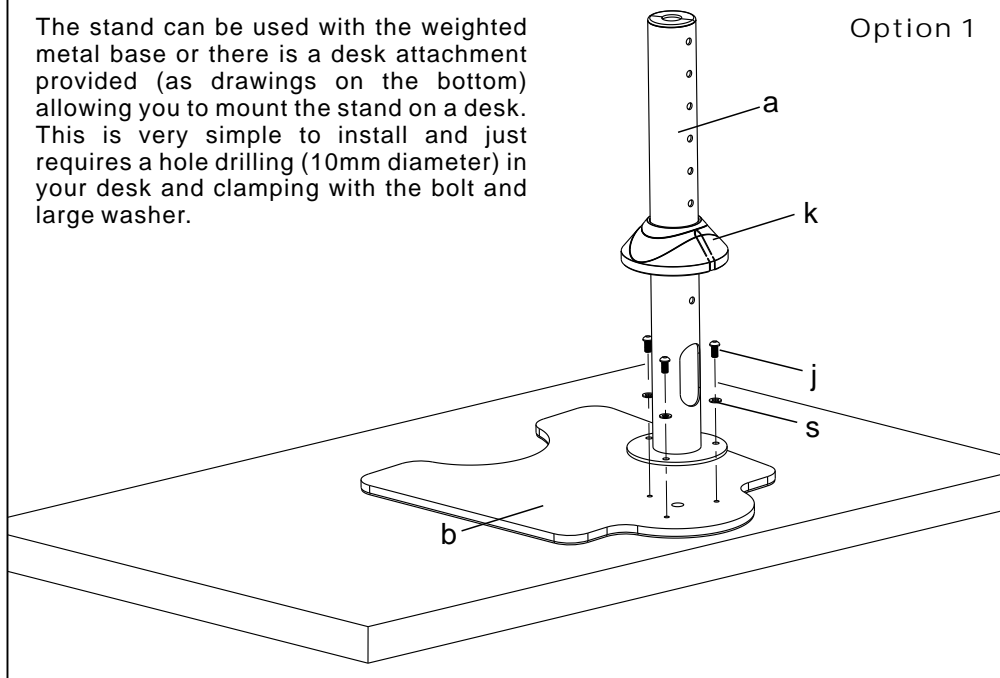

Option 2

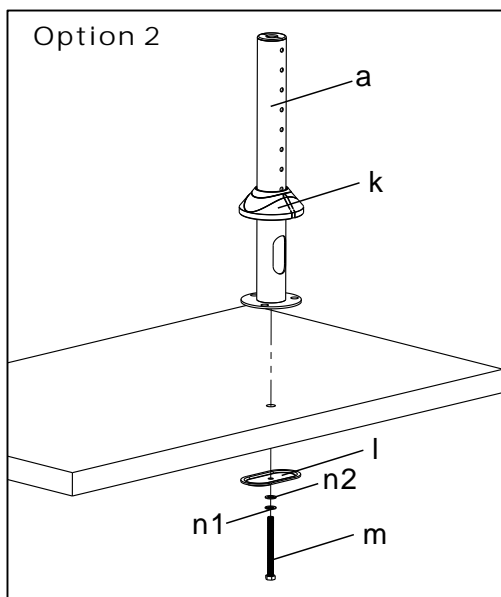

Option 3

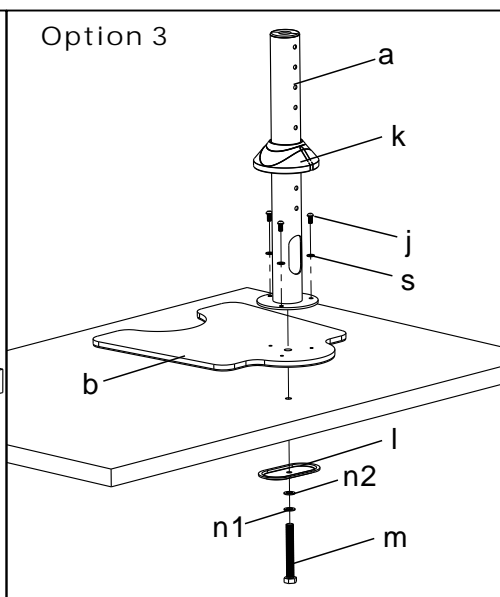

Step 2

Assemble the Arm Sets and Install it on the Pole

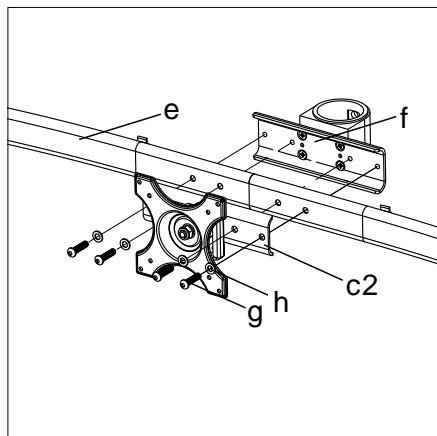

Assemble the curved arm sets as the diagram above, fasten the M6x25 Bolt-g by provided Allen Key-o.

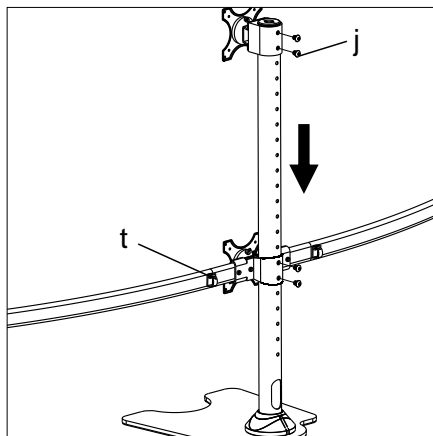

Insert the curved arm sets to pole, fasten the M8x12 Bolt-j by provided Allen Key-o. Install the Wire Clip-t.

Step 3

Mount the Monitors to Two Side VESA Plates

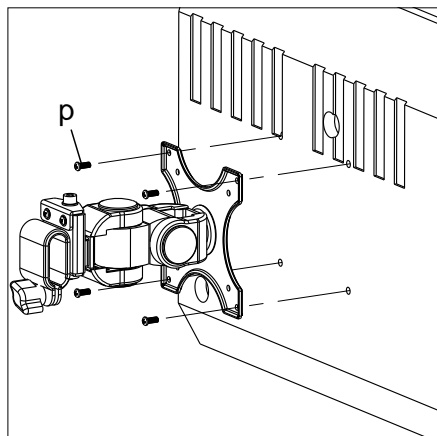

For Flat Back Monitor

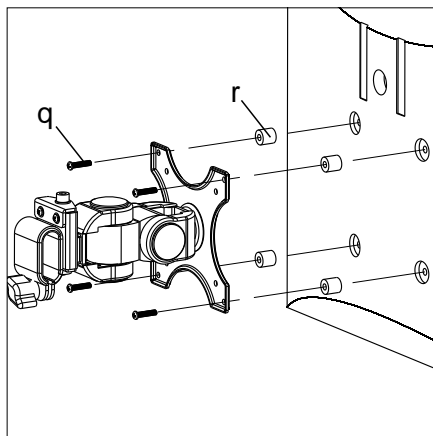

For Curved Back Monitor

Step 4

Mount the Monitors to Middle VESA Plates and attach two side Monitors to Arm Sets

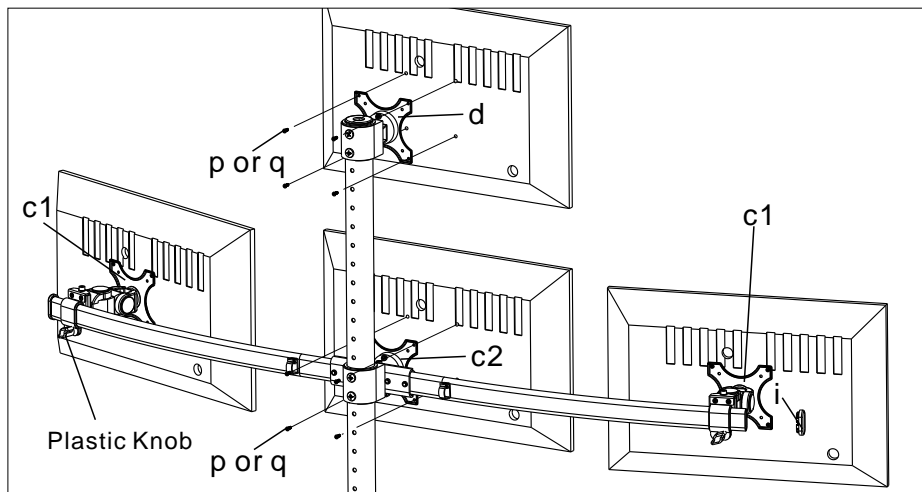

Install the center monitors to Middle VESA Plates(c2 and d) by 8pcs M4x12 Bolts-p(for flat back) or 8pcs M4x30 Bolts-q and 8pcs M4 Spacer-r(for curved back). Attaching the two side monitors to the curved arm sets, fixing the position by the plastic knobs. Install the Arm Plastic Cover(i) as the above diagram.

Step 5

Adjust the Tilting Angle

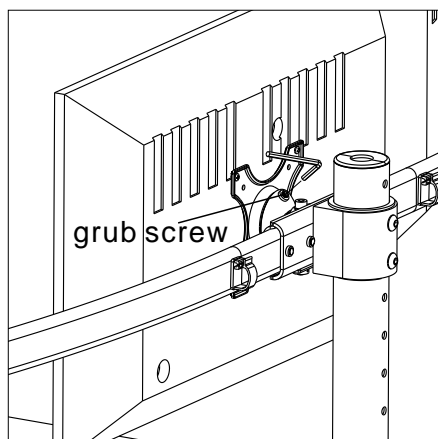

Fasten the grub screw in the middle monitor plate to fix the tilting angle by provided Allen Key(o).

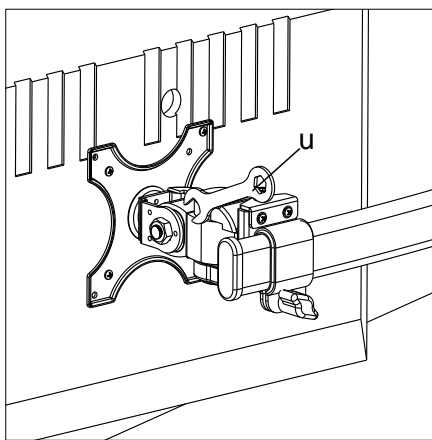

Use the Wrench(u) to tighten the nut if the tilt angle can not be fixed for the monitor plate in the sides.

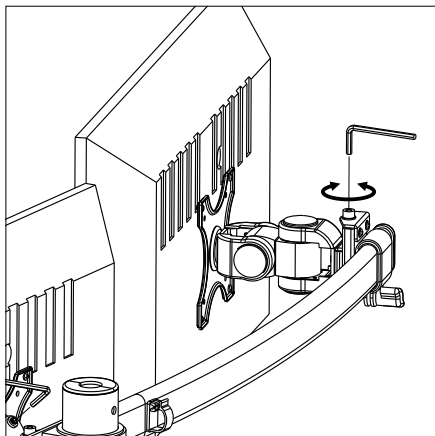

By turn the allen head bolt clockwise or counterclockwise to adjust the level of each monitor.

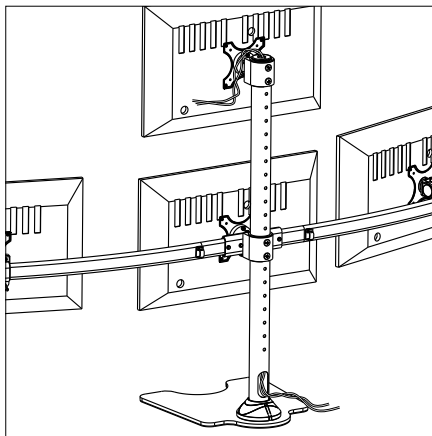

Manage the wires as the above diagram.

Thanks for choosing our products, enjoy the using.